

						SECTION B-B											
												DETAIL-5					
<b>SPECIFICATION :</b>																	
TYPE :				ROLLER BLIND													
OPERATION :				MANUALLY OPERATED													
MOUNTING TYPE :				CEILING MOUNTING TYPE													
FABRIC :																	
MATERIAL :				FIBRE GLASS FABRIC WITH PVC/VINYL COATING OR POLYESTER (PES) FABRIC													
COLOUR :				RAL 9006-WHITE ALUMINIUM													
VISIBILITY :				TRANSLUCENT													
OPENNESS FACTOR :				5 TO 10 %													
FIRE SAFETY :				SHALL COMPLY TO EN 45545-HL3 R1 REQUIREMENTS													
EDGE BINDING :				TO BE PROVIDED													
12	1	-	GRIP-PULL	-	HARD PLASTIC-BLACK COLOUR												
11	1	-	CROSS RECESSED PAN HEAD SCREW	M3x5	IS:7483,MATL: ISO:3506, Gr-A2-70,SS												
10	2	-	CROSS RECESSED PAN HEAD SCREW	M4x10	IS:7483,MATL: ISO:3506, Gr-A2-70,SS												
9	2	-	SET SCREW, SOCKET-HEX HEAD	M3x2.5L-FLAT POINT (FP)	IS: 6094/MATL : ISO 3506, Gr-A2-70,SS												
8	1	-	STOPPER	-	HARD PLASTIC-BLACK COLOUR												
7	1	-	ROPE-PULL	Ø3	ARAMID ROPE												
6	2	-	GUIDE SLIDER	-	HARD PLASTIC-BLACK COLOUR												
5	2	-	GUIDE BRACKET	-	SUS304/AISI304												
4	1	-	GUIDE RAIL RH	Ø6	SUS304/AISI304												
3	1	-	GUIDE RAIL LH	Ø6	SUS304/AISI304												
2	1	-	FABRIC-TRASLUCENT	-	FIRE RETARDAANT GLASS FIBRE FABRIC/(POLESTER(PES) FABRIC												
1	1	-	SUN BLIND HOUSING	-	ASSY												
SL.NO.	QTY	PART / STOCK No.	DESCRIPTION	SIZE	MATERIAL												
					COMPANY STD./S WT. (Kg) MATERIAL												
PRODUCT			MUMBAI METRO CARS - L2 & L7														
REF DRG																	
MATERIAL																	
REAT																	
TREAT																	
SURFACE																	
TITLE																	
APPD			20.03.2020														
REV D			20.03.2020														
CHKD			20.03.2020														
DRWN			20.03.2020														
SCALE			SHEET														
1:3			1 OF 1														
DRG No.			ALT														
bowl BEML LIMITED			525-18088														
ALT.NO.	ECN NO/CHANGES	DATE	BY	CHKD	APPD												

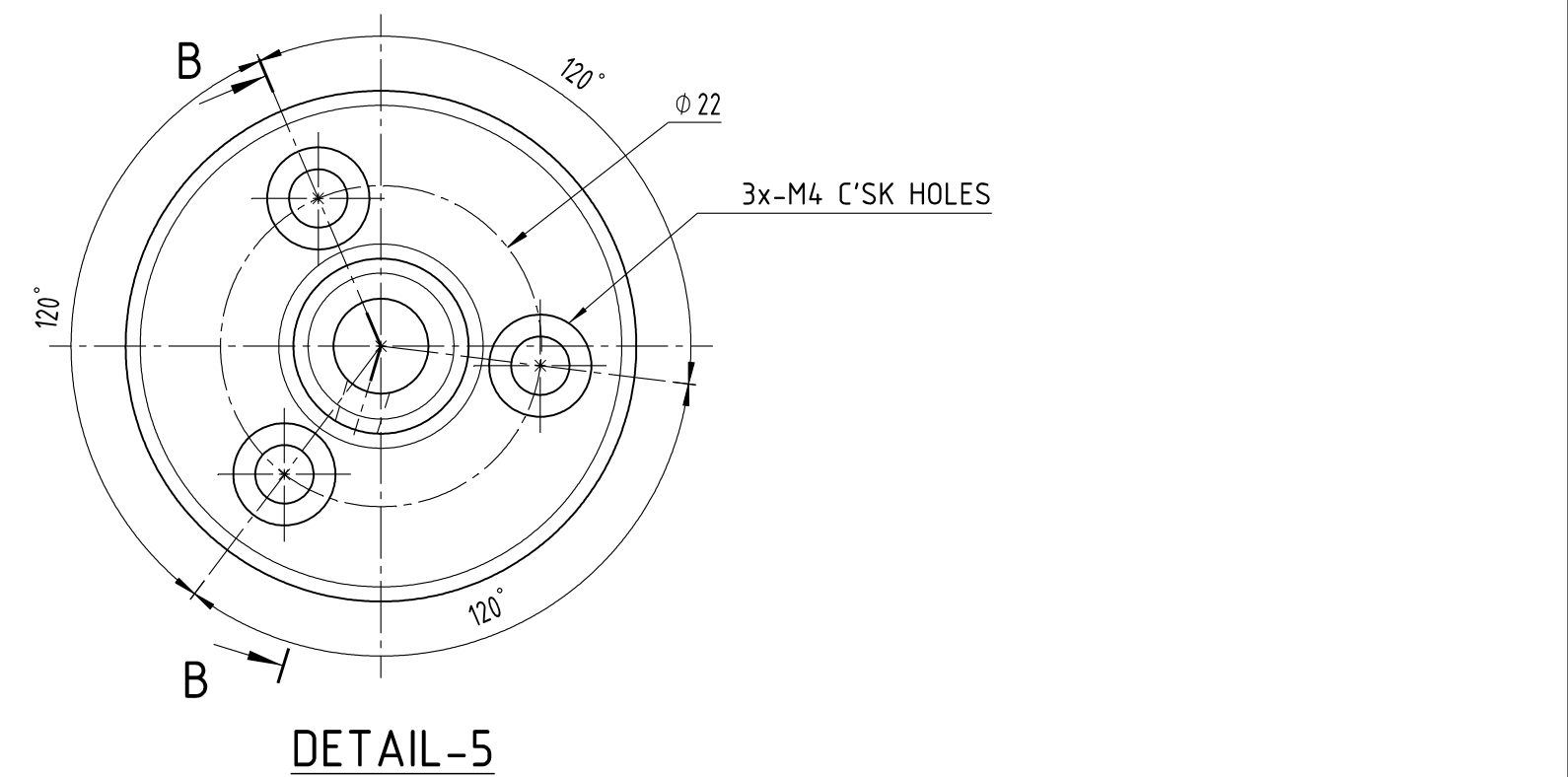

12	1	-	GRIP-PULL	-		HARD PLASTIC-BLACK COLOUR
11	1	-	CROSS RECESSED PAN HEAD SCREW	M3x5		IS:7483,MATL: ISO:3506, Gr-A2-70,SS
10	2	-	CROSS RECESSED PAN HEAD SCREW	M4x10		IS:7483,MATL: ISO:3506, Gr-A2-70,SS
9	2	-	SET SCREW, SOCKET-HEX HEAD	M3x2.5-FLAT POINT (FP)		IS 6094/MATL : ISO:3506 Gr-A2-70,SS
8	1	-	STOPPER	-		HARD PLASTIC-BLACK COLOUR
7	1	-	ROPE-PULL	Ø3		ARAMID ROPE
6	2	-	GUIDE SLIDER	-		HARD PLASTIC-BLACK COLOUR
5	2	-	GUIDE BRACKET	-		SUS304/AISI304
4	1	-	GUIDE RAIL RH	Ø6		SUS304/AISI304
3	1	-	GUIDE RAIL LH	Ø6		SUS304/AISI304
2	1	-	FABRIC-TRASLUCENT	-		FIRE RETARDANT GLASS FIBRE FABRIC/POLESTER(PES) FABRIC
1	1	-	SUN BLIND HOUSING	-		ASSY

SL.NO.	QTY	PART / STOCK No.	DESCRIPTION	SIZE	COMPANY STD./IS	WT. (Kg)
					MATERIAL	
MUMBAI METRO CARS - L2 & L7						
PRODUCT						
REF. DRG						
MATERIAL						
HEAT TREAT						
SURFACE TREAT						
TITLE						
SUN BLIND ASSY-RH						
APPD			REV D		20.03.2020	
CHKD			REV D		20.03.2020	
DRWN			REV D		20.03.2020	
SCALE			1:3		20.03.2020	
SHEET			1 OF 1		WT. -	
DRG No.					ALT	
bent BEML LIMITED					-	
525-18088						

